

# **CRAWLER<sup>®</sup> OUTRIGGER INSTALLATION**

REFER TO CHART ON PAGE 2 TO DETERMINE WHEN OUTRIGGERS ARE NEEDED.

- 1) Install caster E into the square receiver located at the end of outrigger G.  
Install and lock clevis pin F, as shown in fig. 1.

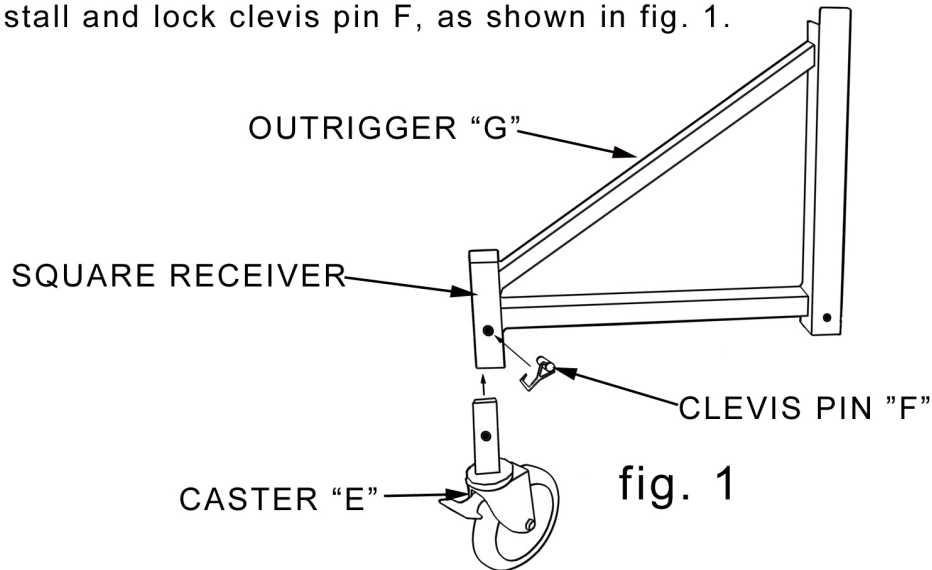

- 2) Temporarily remove clevis pin F from the bottom of end frame A.
- 3) While holding the outrigger G at a 45 degree angle to end frame A, insert the pin located at the top of the outrigger, through the 9th hole from the bottom of the end frame when using 18" outriggers and the 12th hole when using 24" outriggers, as shown in fig.2A. Lower the outrigger, allowing the U shaped channel on the outrigger to seat into the square vertical tube on end frame A.
- 4) Make certain the hole in the bottom of the outrigger aligns with the hole in the bottom of the end frame. Reinstall the clevis pin previously removed in step #2 through the outrigger G, end frame A, and caster E.

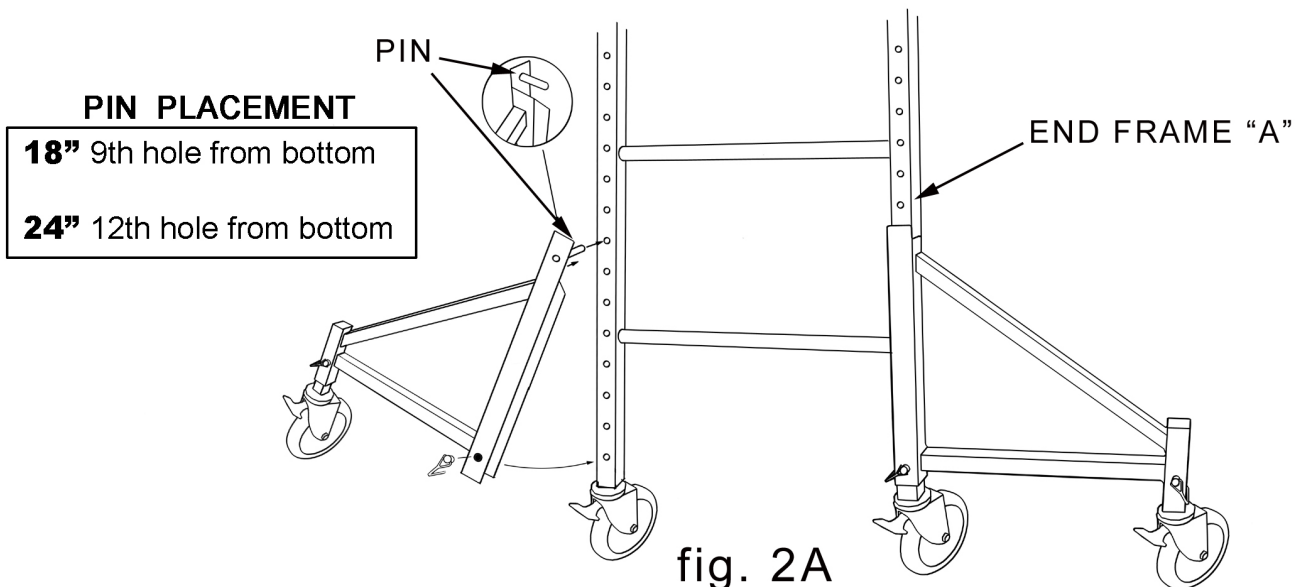

# CRAWLER® OUTRIGGER INSTALLATION

5) Repeat steps 1 - 4 installing all four outrigger as show in fig. 2B.

## WARNING

OSHA reg 1926.452(w)  
(6) (iii) states Outrigger  
frames, when used, are  
installed on both sides  
of the scaffold.

Refer to the chart below  
to determine outrigger  
compliance

## NOTE:

All 4 clevis pins must be installed

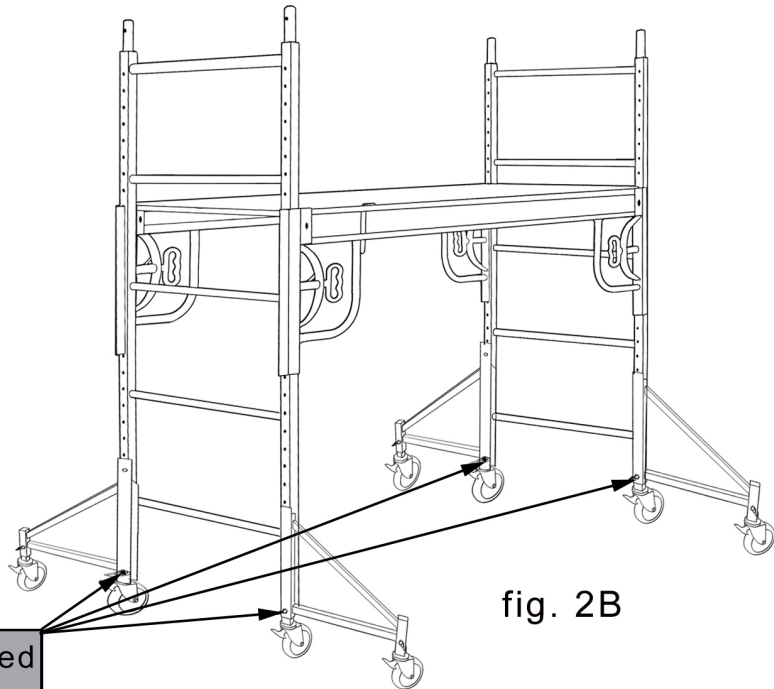

Use the chart below to determine when outriggers and guardrails are needed to be OSHA compliant.

100 Series 200 Series	No. of 6 ft. End Frames	Max. Platform Height	Max. Working Height	Guard Rails Required	Outrigger Required	Meets 3:1 Height to Base Width Ratio	Meets 4:1 Height to Base Width Ratio
100 & 200	1	6'	12' 6"	no	no	yes	yes
100 & 200	2	11' 6"	18'	yes	yes (18")	yes	yes
100 & 200	3	17'	23' 6"	yes	yes (24")	yes	yes

## NOTE:

Crawler Series 100 and 200 scaffolds (4' and 6' platform lengths), have a base width of 29". Base width is the span between the end frames when no outriggers are attached. Attaching outriggers increases base width by the length of each outrigger.

OSHA requires outriggers when the height of the platform exceeds 4 times the base width, (3 time the base width in some areas). As shown in the chart above, to be OSHA complaint, you can have a maximum platform height of 116 inches (4 x 29") without outriggers. State and local laws may be more strict than OSHA.

## EMPLOYEES RIDING ON MOVING SCAFFOLDS

Allowed if "The height to base width ratio of the scaffold during movement is 2;1 or less....." OSHA reg 1926.452 (w) (6) (ii)

